



Certified Installers/Exclusive Dealers - CA, NV, AZ

Helical Anchor Accessories

ECP provides brackets, all-thread adapters and pile caps to fit the many applications for helical anchors. From boardwalk brackets to solar panel bases, utility tower foundations to structural underpinning applications, ECP provides our customers with the accessories needed support their projects. Specialty adapters can be provided to meet specific jobsite needs, upon request.

ECP Helical Accessories:

- Underpinning Brackets
- New Construction Caps
- Solar Panel Bases
- Installation Adapters
- Boardwalk Brackets
- Guy Wire Adapters
- Slab Brackets
- Tieback Transitions
- Soil Nail Adapters
- Porch Brackets

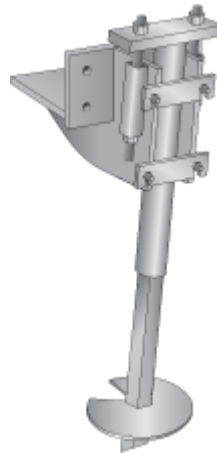

Torque Anchor™ Utility Brackets		
TAB-150-UB & TAB-288L-UB Utility Bracket		
Shaft Size:	1-1/2" Sq.	2-7/8" Dia.
Bracket Designation:	TAB-150-UB	TAB-288L-UB
Pier Cap:	T-Tube Cap	
Ultimate-Limit Capacity:	40,000 lb.1	
Bearing Area:	68-1/4 sq. inches	
Standard Lift Capacity:	4 inches ²	
<p style="text-align: center;">TAB-150-UB TAB-288L-UB</p> <p style="text-align: center;">DETAIL OF TAB-150-UB UTILITY BRACKET & TAB-288L-UB UTILITY BRACKET</p>		



Certified Installers/Exclusive Dealers - CA, NV, AZ

TAB-175-LUB, TAB-288-LUB & TAB-350-LUB Large Utility Bracket			
Shaft Size:	1-3/4" Sq.	2-7/8" Dia	3-1/2" Dia
Bracket Designation:	TAB-175-LUB	TAB-288-LUB	TAB-350-LUB
Pier Cap:3	T-Tube	Pile Cap	Pile Cap
Ultimate-Limit Capacity:	98,000 lb.1		
Bearing Area:	75 square inches		
Standard Lift Capacity:	5-1/2 inches2		
<p>NOTES:</p> <p>1. These are mechanical capacity ratings. Foundation strength and soil capacity will dictate actual capacity.</p> <p>2. Bracket Lift Height Can Easily Be Increased By Ordering Longer Continuously Threaded Bracket Rods.</p> <p>3. The TAB-LUB Bracket is the same component for three different shaft sizes; the Pile Cap configuration varies to accommodate the appropriate shaft for the application.</p>			
<p>DETAIL OF TAB-288-LUB SUPPORT SYSTEM</p>			

Torque Anchor™ Porch & Slab Brackets		
TAB-150-LP Porch Bracket	TAB-150 SSB Slab Bracket	TAB-150-HSB Hydraulic Lift Slab Bracket*



Certified Installers/Exclusive Dealers - CA, NV, AZ

TAB-288-LHSB Hydraulic Lift Slab Bracket*	TAB-288-HSB Hydraulic Lift Slab Bracket*	TAB-150-TB (3.5 x 8) Timber Bracket4

* Load transfer and elevation recovery is accomplished using ECP Steel Pier™ Bracket Lift Assemblies (Purchased Separately) The TAB-150-HSB and TAB-288-LHSB Bracket requires an ECP Model 300 Lift Assembly and the TAB-288-HSB Bracket requires an ECP Model 350 Lift Assembly.

- The capacities listed for foundation brackets are mechanical ratings, and the actual installed load capacities are dependent upon the strength and condition of the concrete, and the specific soil conditions on the job site. Concrete strength for the above ratings was assumed to be 3,000 psi.
- Bracket lift height may be increased by ordering longer continuously threaded bracket rods.
- Capacities based upon “soft” soil values “N” > 5 blows per foot
- Special configurations to fit your project can be fabricated to your specifications upon request. Allow extra time for processing.

Pile Cap Notes:

1. Capacities based upon 3,000 psi concrete. Reduce loading or increase plate area appropriately for lower strength concrete.
2. Pile caps shown are standard items and are usually available from stock. Note: TAB-288L-T and TAB-288-T are not interchangeable because bolt hole spacing varies.
3. Part numbers for tension include attachment holes and SAE J429 Grade 8 hardware as shown; compression pile caps do not include hardware or mounting holes.
4. Compressive capacity ratings of some pile caps are limited by compressive pile shaft capacity.
5. Pile caps are supplied plain steel -- hot dip galvanized per ASTM A123 Grade 100 is available.
6. Configuration for the TAB-225 N/C 1 (12 x 12) Pile Cap is slightly different than illustrations



*Custom fabricated pile caps are available for all shaft sizes by special order – allow extra time for processing.



Certified Installers/Exclusive Dealers - CA, NV, AZ

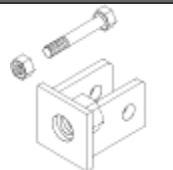
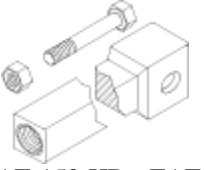

Certified Installers/Exclusive Dealers - CA, NV, AZ

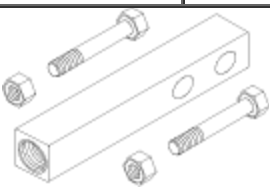
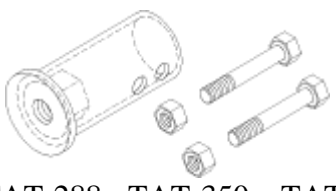
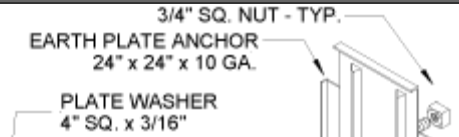
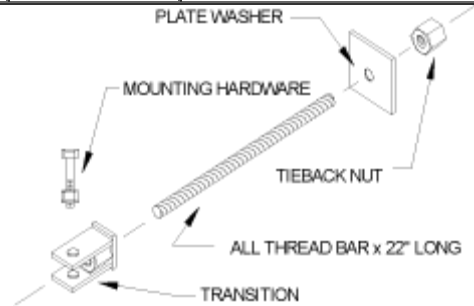
Torque Anchor™ Transitions & Wall Plates						
Transition Assemblies				Stamped Wall Plates		
 <p>TAT-150-LD</p>  <p>TAT-150-HD - TAT-175</p>	TAT-150-LD	TAT-150-HD	TAT-175	TAT-225	PA-SWP	PA-LWP
	Output Thd. Major Dia. 1" (B-12 Coil Rod)	Output Thd. Major Dia. 1-1/8" (WF-8)	Output Thd. Major Dia. 1-3/8" (WF-10)	Output Thd. Major Dia. 1-7/8" (WF-14)	12" x 18" 216 Sq. In. Bearing Area	12" x 26" 312 Sq. In. Bearing Area
	Plate Washer 3/8" x 5" x 5"	Plate Washer 3/8" x 5" x 5"	Plate Washer 3/8" x 6" x 6"	Plate Washer Not Supplied		Wall Plates include: Flat Washer 3/16" x 4" Sq. Hot Dip Galv.
Ultimate-Limit Capacity 38,000 lb.	Ultimate-Limit Capacity 70,000 lb.	Ultimate-Limit Capacity 99,000 lb.	Ultimate-Limit Capacity 225,000 lb.	Clamping Capacity: 8,250 lb		
 <p>TAT-225</p>	TAT-288	TAT-350	TAT-450	Transition Notes: 1. Transitions listed are standard items; usually available from stock. 2. Hot dip galvanized per ASTM A123 Grade 100 3. The capacities listed are mechanical ratings. 4. All Transitions are supplied with 22" All Thread Rod, Nut and Mounting Hardware. Square shaft transitions also have a flat washer included with the exception of the TAT-225 Transition. (See Sketch Below)		
	Output Thd. Major Dia. 1-3/8" (WF-10)	Output Thd. Major Dia. 1-3/8" (WF-10)	Output Thd. Major Dia. 1-1/2" (WF-11)			
Plate Washer Not Supplied. Order Separately to the Engineering Requirements						
 <p>TAT-288 - TAT-350 - TAT-450</p>	Ultimate-Limit Capacity 100,000 lb.	Ultimate-Limit Capacity 120,000 lb.	Ultimate-Limit Capacity 140,000 lb.			
	Plate Anchor Kit					
<p>ECP Earth Plate Anchors are supplied as illustrated below. The wall plate area is 2.2 ft² and the soil bearing area is 3.0 ft². The ultimate-limit tension capacity is 10,000 lb. The plate spacing is adjustable from 9 ft to 17-1/2 ft. (Details on pages 99-101)</p>						
						



Certified Installers/Exclusive Dealers - CA, NV, AZ



Certified Installers/Exclusive Dealers - CA, NV, AZ

The sketch above shows the components that are shipped with solid bar transition assemblies. The Transition and the hardware required to attach the Transition to the Tieback will vary depending upon the product ordered. Please refer to the table above for additional details. Tubular transitions and TAT-225 do not include a flat wall plate. As the angle of installation usually varies generally from 150 to 300, bevel washers should be ordered separately.

Torque Anchor™ Pile Caps

PRODUCT DESIGNATION	FITS TORQUE ANCHOR	ULT.-LIMIT CAPACITY ^{1, 3}	LIFT CAPACITY ²	PRODUCT DESIGNATION	FITS TORQUE ANCHOR	ULT. LIMIT CAPACITY ^{1, 3}	LIFT CAPACITY ²
TAB-150-LP	1-1/2" Sq	9,000 lb	4-1/2"	TAB-288-LHSB (8" Dia. Hole)	1-1/2", 1-3/4" Sq. & 2-7/8" Dia.	20,000 lb	4"
	1-3/4" Sq.	16,000 lb					
TAB-150 SSB (8" Dia. Hole)	1-1/2" Sq.	8,000 lb	4-1/2"	TAB-288-HSB (10" Dia. Hole)	1-1/2", 1-3/4" Sq. & 2-7/8" Dia.	40,000 lb	4"
TAB-150 HSB (8" Dia. Hole)	1-1/2" Sq.	20,000 lb	4"	TAB-150 TB	1-1/2" Sq.	20,000 lb	N/A

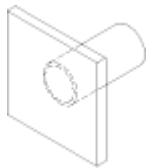

Compression (No Bolts)

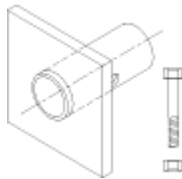

Tension Illustration "A" (One Bolt)

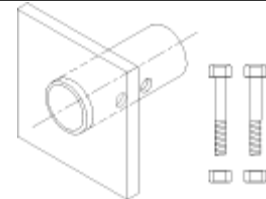

Tension Illustration "B" (Two Bolts)

Square Bar Torque Anchor™ Pile Caps

Part Number (Compression)	TAB-150 NC 1/2 (6x6)	TAB-175 NC 3/4 (8x8)	TAB-288L NC 1/2 (6x6)
Part Number (Tension)	TAB-150-T 1/2 (6x6) A	TAB-175-T 3/4 (8x8) A	TAB-288L-T 1/2 (6x6) A
Pier Size	1-1/2" Sq. Bar	1-3/4" Sq. Bar	2-7/8" Dia. Tubular



Certified Installers/Exclusive Dealers - CA, NV, AZ



Certified Installers/Exclusive Dealers - CA, NV, AZ

Bearing Plate	1/2" x 6" x 6"	3/4" x 8" x 8"	1/2" x 6" x 6"
Pier Sleeve	2-3/8" Dia. x 5-3/4"	2-7/8" Dia. x 7-3/4"	3-1/2" Dia. x 5-3/4"
Ultimate-Limit Compressive Capacity	55,000 lb	70,000 lb	55,000 lb.
Ultimate-Limit Tension Capacity	40,000 lb	70,000 lb.	40,000 lb.
Tubular Torque Anchor™ Pile Caps			
Part Number (Compression)	TAB-288 NC 3/4 (8x8)	TAB-350 NC 3/4 (8x8)	TAB-450 NC 1 (10x10)
Part Number (Tension) NOTE 2	TAB-288-T 3/4 (8x8) B	TAB-350-T 3/4 (8x8) B	TAB-450-T 1 (10x10) B
Pier Size	2-7/8" Dia. Tubular	3-1/2" Dia. Tubular	4-1/2" Dia. Tubular
Bearing Plate	3/4" x 8" x 8"	3/4" x 8" x 8"	1" x 10" x 10"
Pier Sleeve	3-1/2" Dia. x 7-3/4"	4" Dia. x 7-3/4"	5-9/16" Dia. x 9-3/4"
Ultimate-Limit Compressive Capacity	70,000 lb.	70,000 lb.	120,000 lb.
Ultimate-Limit Tension Capacity	70,000 lb.	70,000 lb.	120,000 lb.



Certified Installers/Exclusive Dealers - CA, NV, AZ